

Kit for aerobatic light planes.

INSTALATION GUIDE

Index	Page
Disassembly-----	3
Drill operations on gear box-----	7
New manifold assembly-----	8
Refrigeration system assembly-----	11
Oil system assembly-----	12
Ignition system assembly-----	14

Instructions:

Warning: Verify that the magnets are disconnected (OFF)) and shutoff the Master switch (Master OFF or remove the positive terminal of the battery)

- 1) Disconnect the throttle and primer controls.

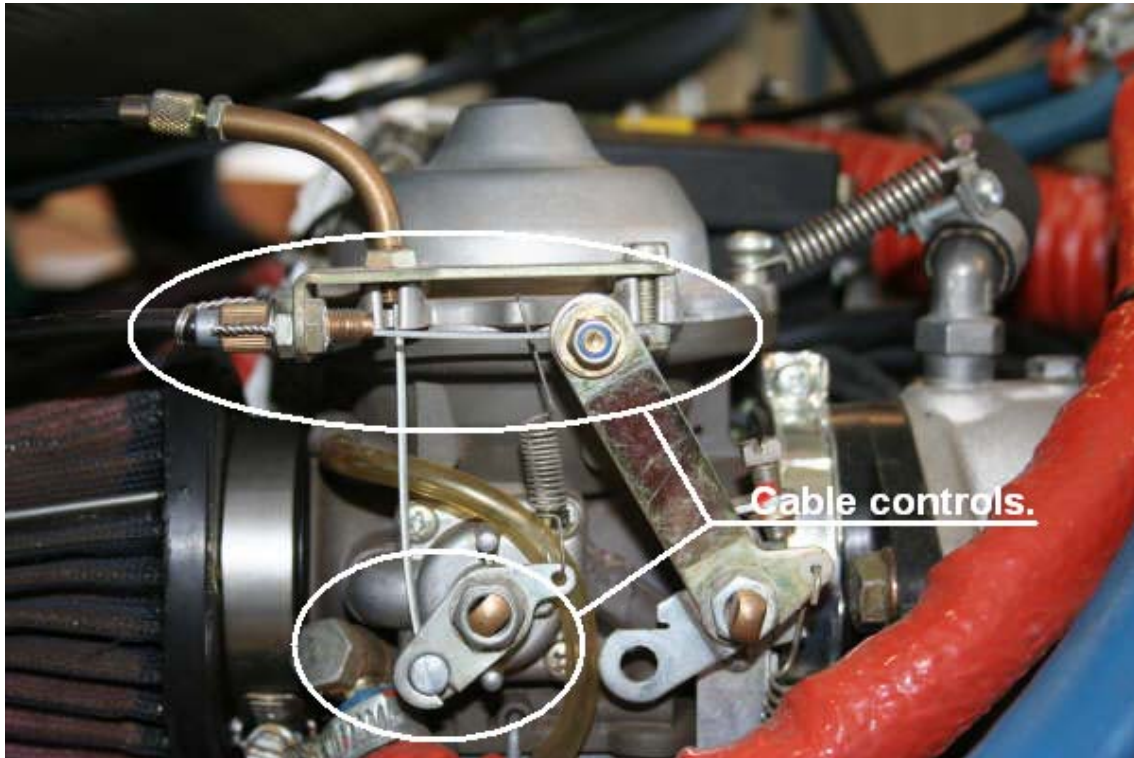

- 2) Loosen and remove the fuel hoses.
- 3) Remove the carburettor manifold socket.

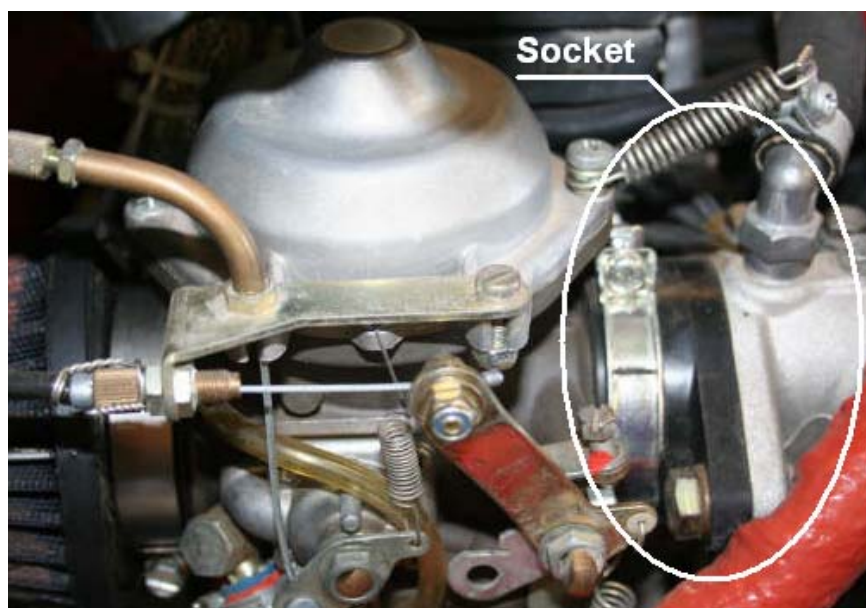

Installation guide for aerobatics aircrafts

- 4) Unplug the masses of the right manifold.
- 5) Remove the right and left manifold of the engine.
- 6) Disconnect the spark plug wires.

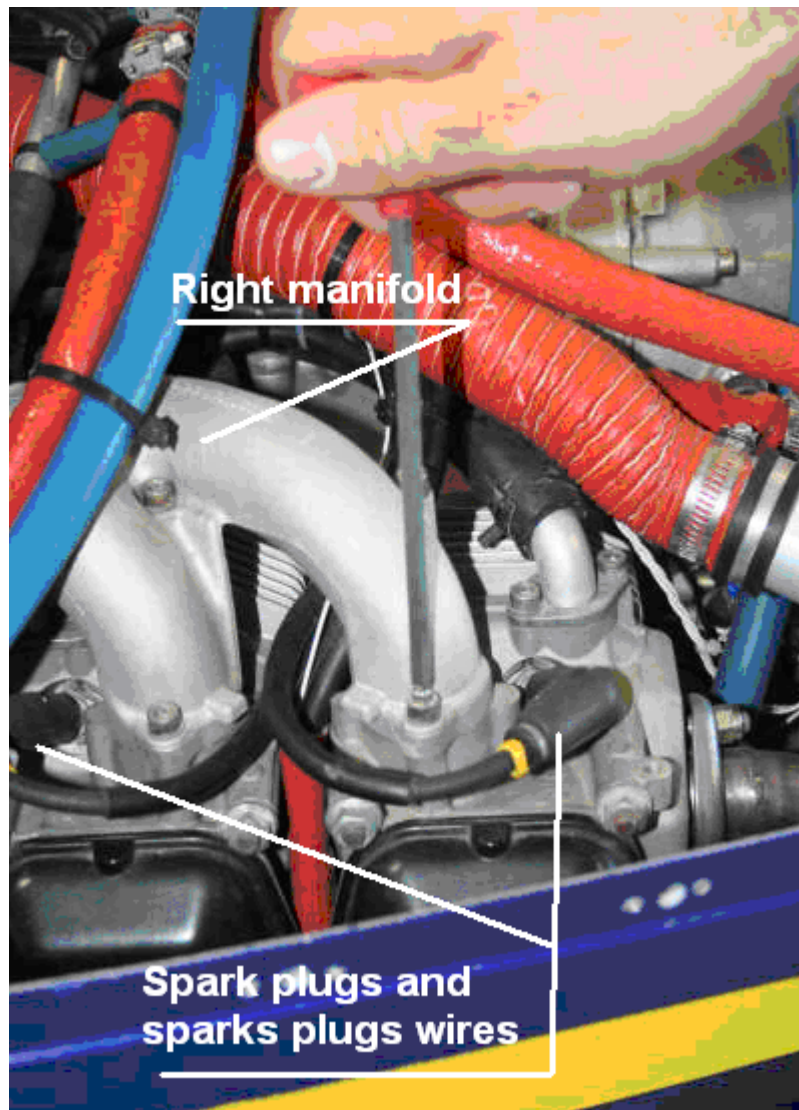

CAUTION: once removed the manifold of the engine, plug the holes input cylinders



Installation guide for aerobatics aircrafts

- 7) Remove the electronic ignition box (Coil Assembly Module).



- 8) Open the clamps from the water tubes and remove the Water Tube Distributor.



- 9) Remove the propeller.
- 10) Disconnect hoses IN and OUT fuel pump motor fuel

11) Unmount the box GEAR SET reduces engine.

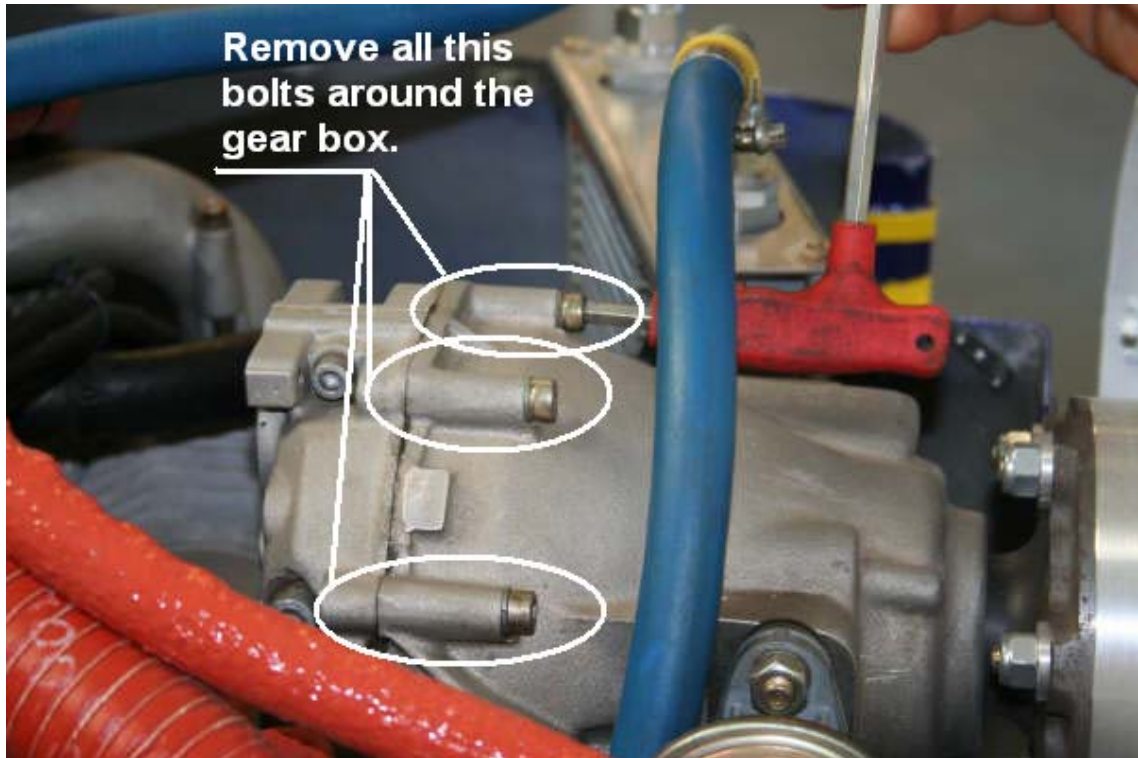

Drill operations

12) Drill a hole in the GEAR SET diameter 11,75 mm and threading with a male of ¼" – 19 BSP

Cation: Don` t drill to deep in the gear box.

Cover the sensitive elements of the box of chips and operating threaded holes.

Before returning to the service, blowing compressed air and clean any debris chip.

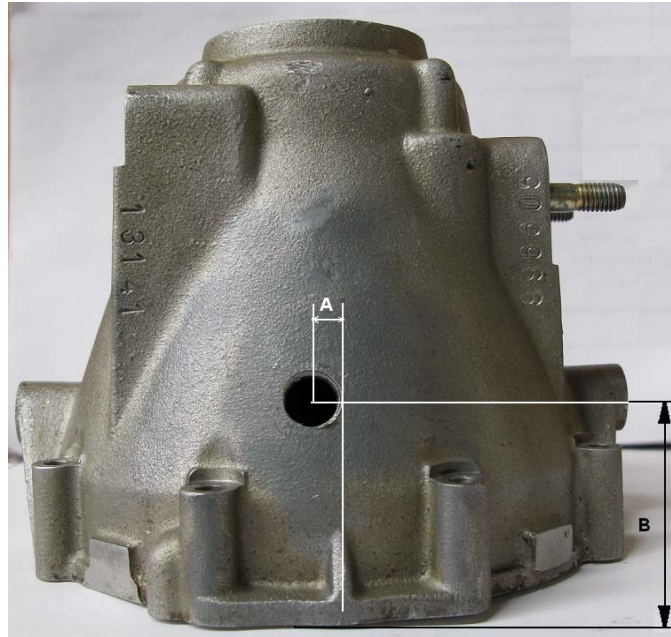

Distance A (máx): 10mm.

Distance B: 50 mm.

10) Screw the Angular Tube with Locktite 648 (Green)



11) Mount the gear box. Apply Locktite 574 in the contact surfaces between engine and gear box.

12) Put the screw Allen with Locktite 221.

13) Apply a torque 2 dan x m. to the Allen screw.

New manifold assembly

- 14) Assemble the new intake manifold and carburettor, as shown.
Carburettor must go to the firewall.

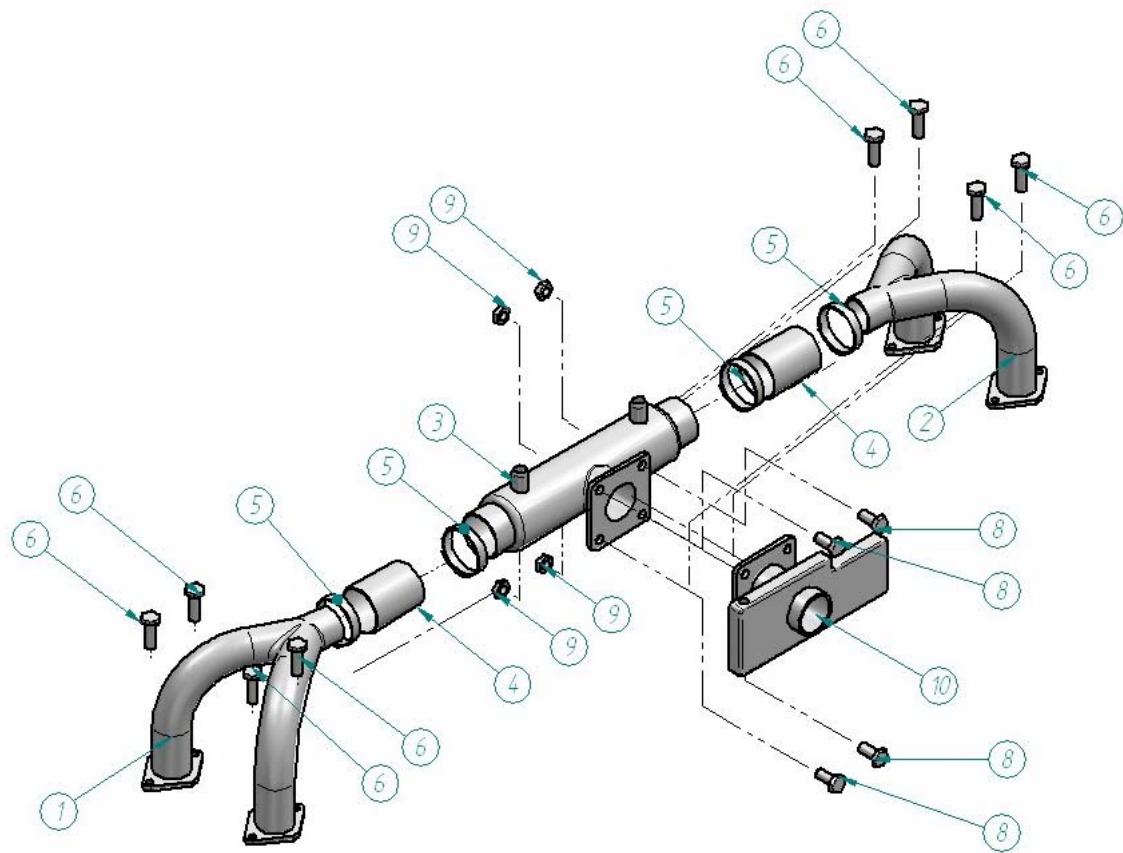

Parts list			
N° Ident	Name	Qty	Observations
1	Left engine intake pipe	1	
2	Right engine intake pipe	1	
3	central intake tube	1	
4	Hose coupling	2	
5	Clamps	4	
6	Mounting screws admission	8	M6 x 12
7	Washer	8	
8	Carburetor mounting screws	4	AN4_10
9	Carburetor mounting nuts	4	

- 15) Mount the intake on the engine with the screws (6, see the previous table) as shown below

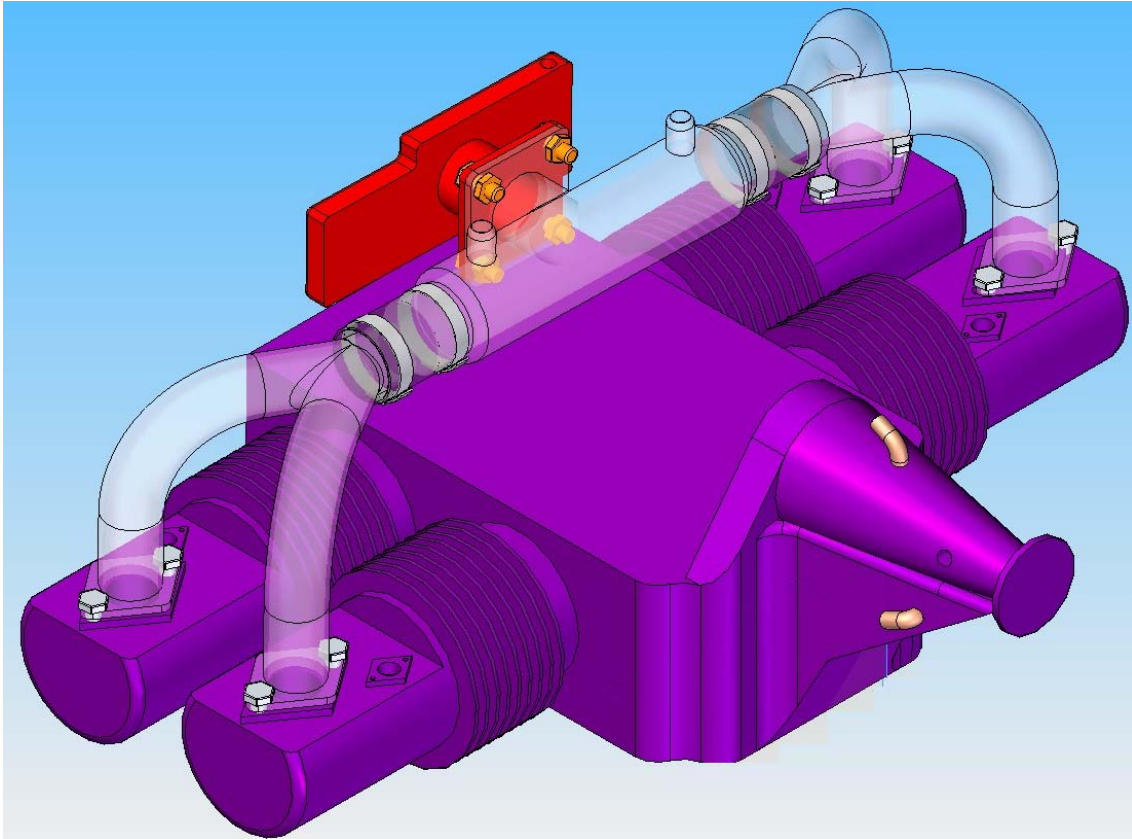

- 16) Mount the switch temporarily hot air into the carburettor.

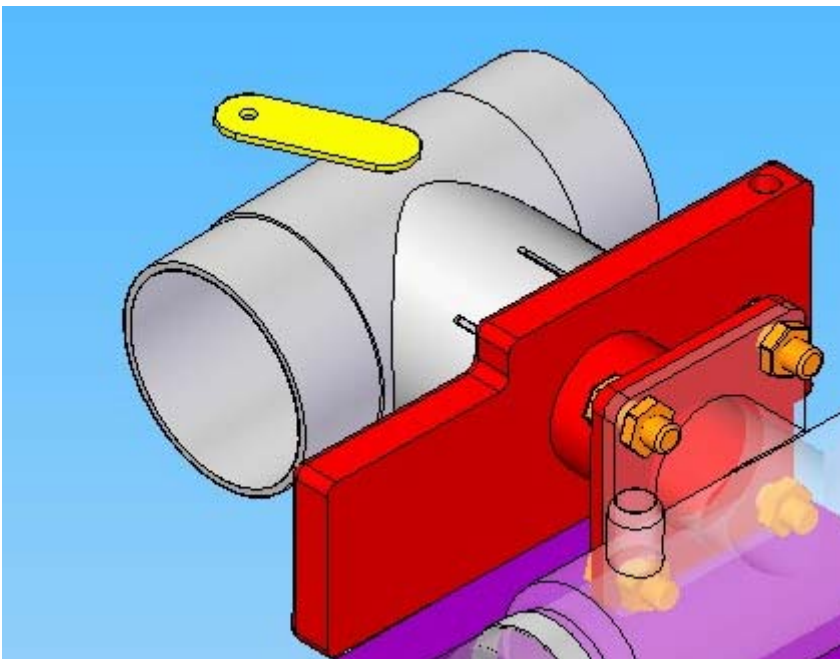

Installation guide for aerobatics aircrafts

Details of the hot air selector assembly, side view.



Details of the hot air selector assembly, seen from above.



The hot air selector is fixed to the carburettor with a clamp of 27 to 61 mm



Refrigeration system assembly

20) Mount the Water Distributor shifted to the right of the airplane as photo

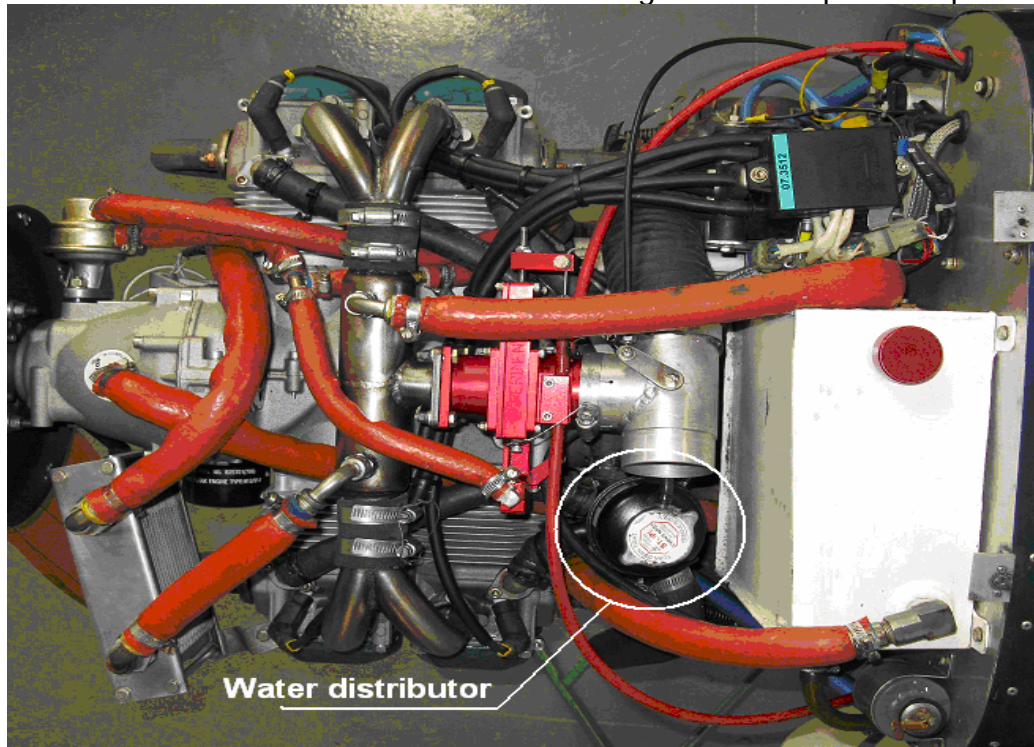

20.1) Connect the water tubes as follows

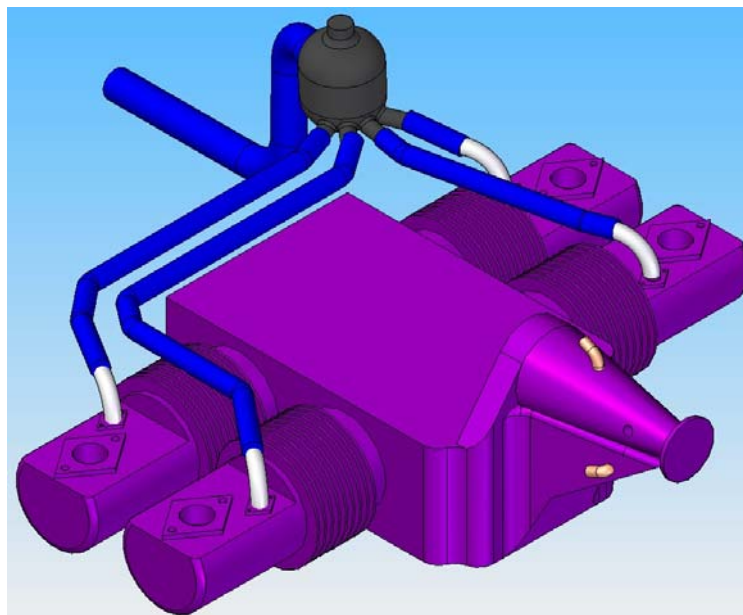

20. 1) Loosen the Bent Socket screws from cylinder N°4 and rotate the curve about 30 °. Connect hoses as follows

20.2) Replace the hose "water tube 922542" 270 mm long for 420 mm long from the cylinder 1 to water distributor.

21) Connect the coolant hoses from other cylinders.

Oil system assembly

22) Drill the firewall according to oil tank holes dimensions and mount it on the firewall.

23) Connect hoses oil as follows.

- 1) Connect a hose from the angular tube of 45 degrees (1), mounted up in the gear box to the oil tank (2), indicated hose bronze
- 2) From the output of oil radiator (3), connect the hose to intake manifold (4), indicated in yellow hose.
- 3) From the exit of the intake manifold (5), connect the hose to the oil tank (6), shown in green hose.
- 4) The higher output of the oil tank (7), connect the hose to the engine crankcase (8), indicated in red hose.
- 5) From the radiator oil (9), connect the hose to take located on the side of the box reducing motor (10), indicated in orange hose.
- 6) Connect a hose at the exit (11) for the gas venting to the outside.

On this page shows the routing of the hoses oil flow

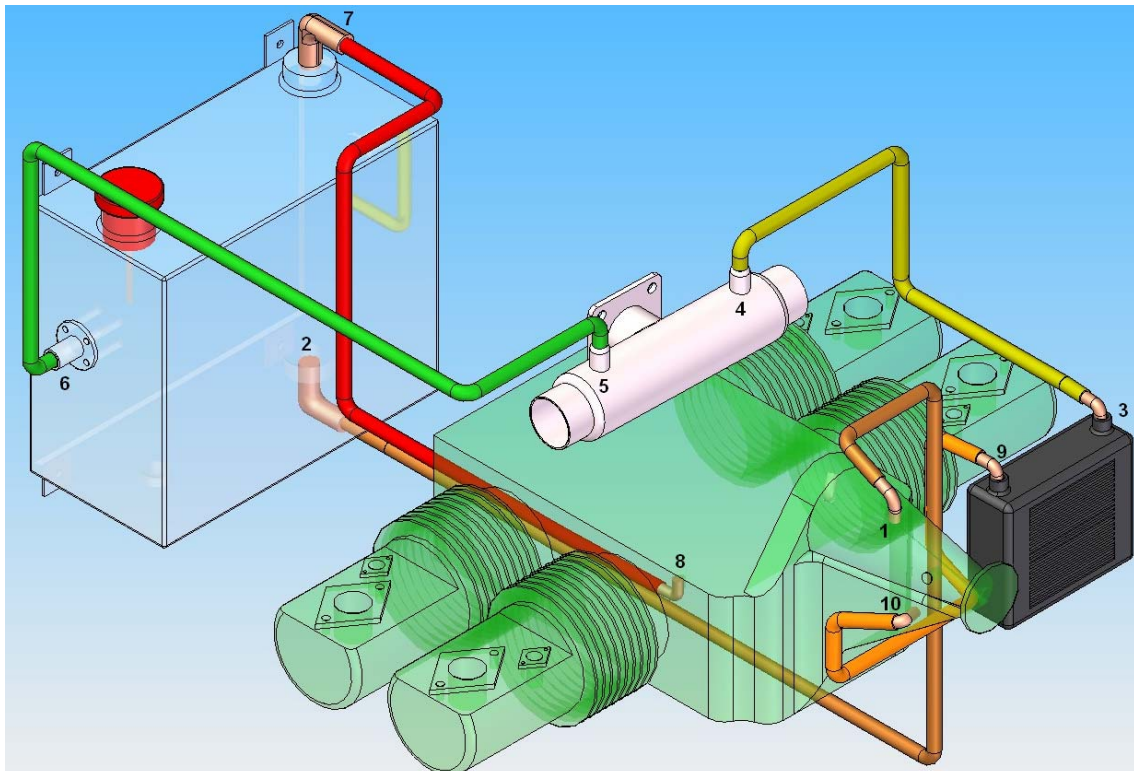

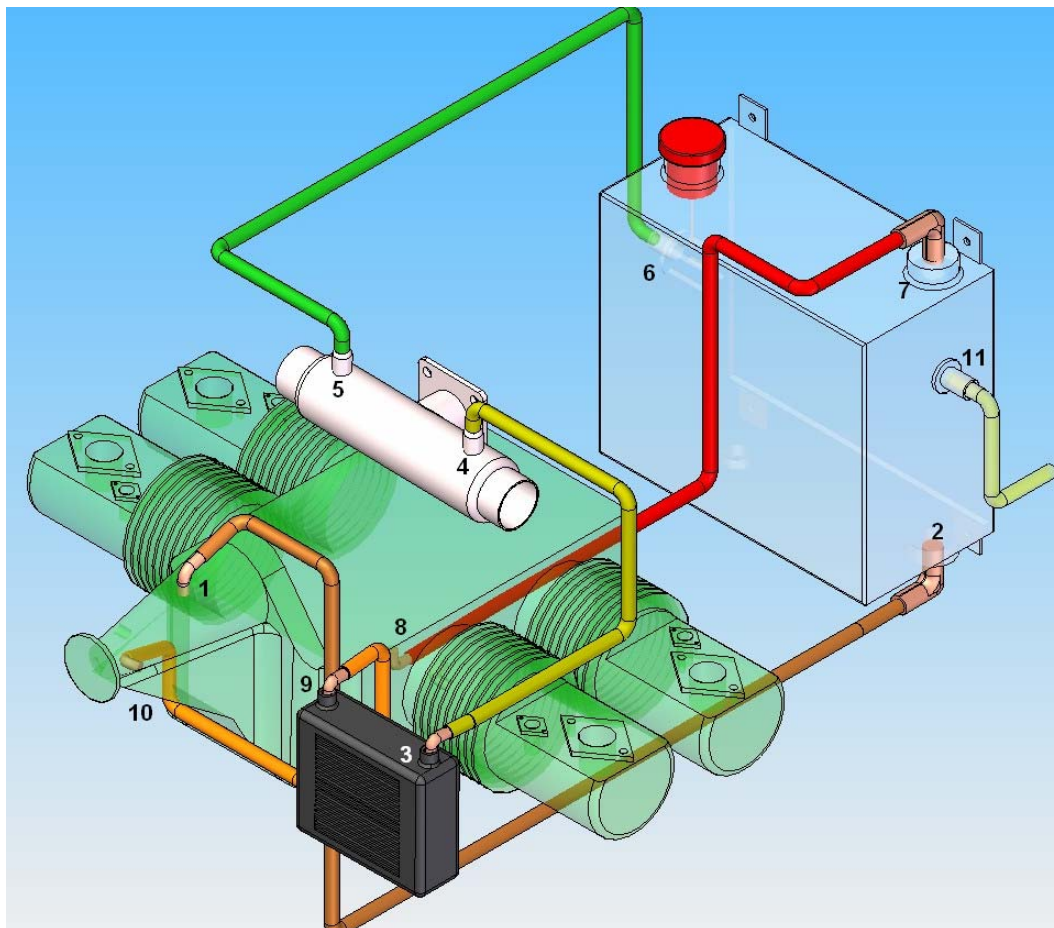

24) Connect the fuel system as shown in the following schedule:

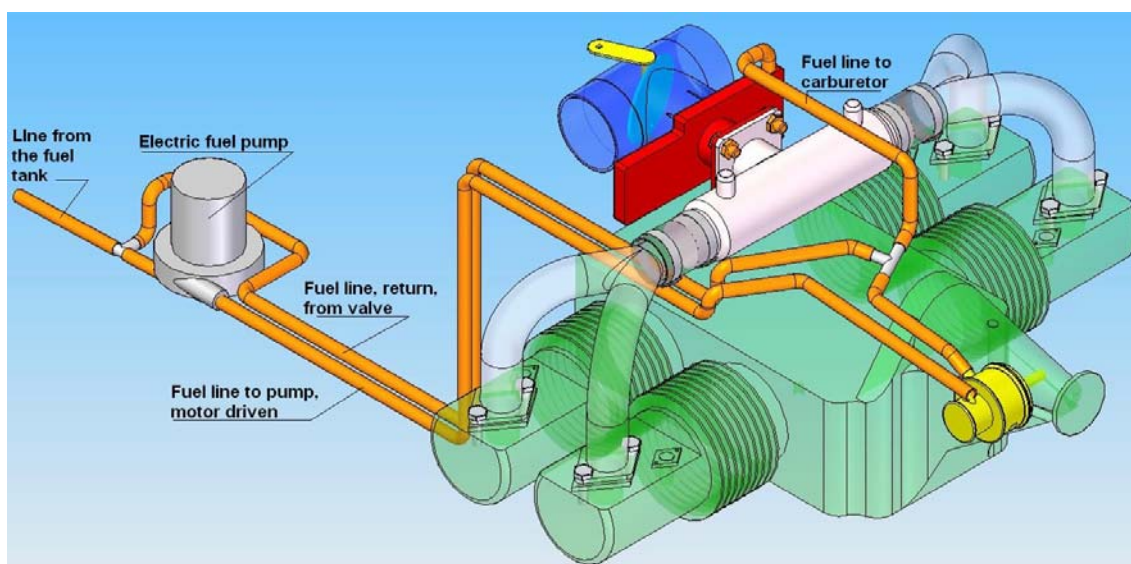

Ignition system assembly

25) Install the carburettor according to the manufacturer's manual.

26) Install "Coil Module Assembly" on a support (not included) in the firewall.
Attached photos of installation example





CAUTION: Make sure that bonding from ignition coils are surely connected with the engine.

27) Replace the spark plug wires below the cylinder 2 and 4 by others, some 30 cm longer.

28) Use to connect the sparks plugs of upper cylinders 2 and 4 the wires reemployed in the in the lower cylinder spark plugs 2 and 4

Complete assembly

